

Features

- ★ Small size
- ★ Stable frequency
- ★ Cold welding package
- ★ Reliable performance

Application

- ★ Telecommunication system
- ★ Base station
- ★ Satellite systems



Specification (Characteristics)

FREQUENCY CHARACTERISTICS				
Parameters	Min	Max	Units	Condition
Frequency range	10.0	120	MHz	
Frequency calibration	0.1(SC) / 0.25 (AT)		±ppm	@25°C
Frequency stability over temperature	±5, ±10, ±20, ±50, ±100 ppb (AT cut) ±3, ±5, ±10, ±30, ±50 ppb (SC cut)			
Supply voltage stability	0.0005	0.1	±ppm	±5%@25°C
Load sensitivity	0.0005	0.05	±ppm	±10%@25°C
Short term stability	5E ⁻¹⁰ /S		5E ⁻¹¹ /S	
Aging/year	AT Cut	≤±0.5 ppm/year (standard)		≤±0.005 ppm/day(max)
	SC Cut	≤±0.05 ppm/year (standard)		≤±0.001 ppm/day(max)

Dimension (Unit: mm)

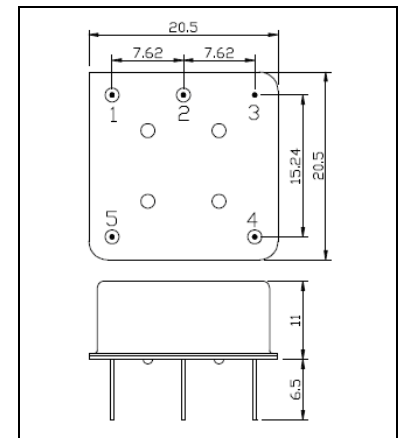

Pin Connection

PIN 1	Supply Voltage
PIN 2	Freq output
PIN 3	GND
PIN 4	N/C (or V Control)
PIN 5	Vref (or N/C)

POWER SUPPLY				
Parameters	Min	Max	Units	
Supply voltage	+3.0	+12.0	V±5%	
Current	Start up	150	800	mA@25°C
	Steady	80	300	

OSCILLATOR OUTPUT			
Parameters	Min	Max	Units
Output waveform	S : Sine	M : CMOS	T : TTL
Output load resistance	50Ω	10kΩ//10pF	1kΩ//15pF

Part Number and Ordering

Part Number Code	Holder Type + Frequency + Tolerance + Stability VS Temp. + Operating Temp. + PPM/VDC + Input Voltage
Ordering Code	Same as Above
Example	OCXO-N20-25.0M-0.3-0.1-0/70-15/5-5V